

Carleton College

ALUMNI ADVENTURES

Explore the world

With Carleton Professors DANA & STEPHEN STRAND

The Mediterranean Sea and Civilization

A Voyage from Rome to Lisbon

Aboard the All-Suite, 50-Cabin *Corinthian*

October 14 – 25, 2015

NEW REDUCED RATES

- Save **\$2,800** per couple
- For solo travelers, single supplement waived plus save **\$1,400** per person



Court of the Lions in the Alhambra complex

Dear Carleton College Alumni and Friends,

This coming autumn, when the days are still warm and welcoming and the crowds of summer have gone, we invite you to **join Carleton College Professors Dana and Stephen Strand on a leisurely voyage from Rome to Lisbon**. Cruising to Sicily and Sardinia and then on to the coast of Iberia, you will enjoy the unspoiled beauty of towns and villages tucked away from major cruise routes—in places like **Porto Torres** and the Catalan countryside around **Tarragona**. And you will encounter the legacy of civilizations spanning the centuries from 3,000-year-old Neolithic structures and Greco-Roman ruins to the medieval charms of the Costa Brava and the uniquely Portuguese Manueline style.

Call at sites well-known and justly famous—the magnificent Doric temple at **Segesta** in the hills above Trapani, for example, and the incomparable **Alhambra** in Granada, the very pinnacle of Islamic architecture. But what sets this voyage apart is the inclusion of lesser known, equally compelling sites like the Cistercian Monastery of **Poblet** outside Tarragona and the Roman city of **Italica**, birthplace of the Emperor Trajan, near **Seville**. We are delighted that Dartmouth **Professor of Classics Roger Ulrich** will be aboard to serve as our interlocutor with the cultures of the past.

There is, of course, much more to the western Mediterranean than its past, and any consideration of this part of the world would be incomplete without some assessment of the issues of the present day along the European, southern, and eastern shores of the Mediterranean. **Carleton Professors Dana and Stephen Strand** will address current events in the region, such as Spain's economy and the European Union, immigration and issues of multiculturalism, as well as comparative and complementary perspectives on the contemporary relationship between the northern and southern shores of the Mediterranean. In addition, **Ambassador Mark Johnson**, whose distinguished career at the Department of State was devoted primarily to the Middle East, will talk about the origins of U.S. involvement in the region and the legacy, once so hopeful and now ominous, of the Arab Spring.

Please take a moment to look over the specially chosen sites on this itinerary and **imagine the rich intellectual exchange** you can have with the onboard experts and your fellow travelers about all things ancient and modern. Then, I encourage you to contact the Alumni Adventures office today at carleton@studytours.org or **(800) 811-7244** to reserve your suite aboard *Corinthian* for an engaging and inspiring ten days in the Mediterranean.

Sincerely,

Robert D. Smulian, Class of '78
President, Carleton College Alumni Association

Cruise, Learn & Be Inspired

Our voyage is accompanied by experienced lecturers and expert local guides who will introduce you to the culture, history, and economies of these unforgettable lands.

CARLETON COLLEGE FACULTY LEADERS



Dana Strand is Andrew W. Mellon Professor of French and the Humanities at Carleton College, where she teaches courses on 20th- and 21st-century French and Francophone literature, with a special emphasis on North Africa. The founding director of the European Studies concentration at Carleton, she also serves on the Middle Eastern Studies Initiative. Dana has led student programs to Paris, southwestern France, and Morocco.



Stephen Strand is the Raymond Plank Chair of Incentive Economics at Carleton College. He has recently taught courses in the Economics of the European Union, the Political Economy of the Turkish Republic, Turkey and the European Union, and a two-term course in

Accounting and Management Science. Steve recently spent a fall term at Georgetown University's McGhee Center for Eastern Mediterranean Studies in Alanya, Turkey, as an Affiliate Visiting Professor. He has led student programs to Egypt, Turkey, and Morocco; to Paris; and to Cambridge University in England.

ALSO ONBOARD



Ambassador Mark Johnson was a career foreign service officer, serving as Ambassador to Senegal, as Deputy Inspector General of the State Department, Deputy Chief of Mission in Kuwait in 1991, and as Deputy Chief of Mission in Cairo, Egypt. He was involved with the Middle

East peace process and the Iranian hostage crisis. Mark is the former national Vice Chair of the World Affairs Councils of America and is the Founder of the World Affairs Council of Montana. He is a Mansfield Adjunct Professor at the Maureen and Mike Mansfield Center at the University of Montana.



Roger Ulrich, Ralph Butterfield Professor of Classics and former Chair of Classics at Dartmouth College, has been teaching Roman art, archaeology, and Latin since 1989. He has lectured to alumni groups in Italy, Spain, France, Jordan, Egypt, and Croatia, and has conducted

field research, including excavation, in Spain, Italy, Greece, and Tunisia. He was the senior editor of *Blackwell's Companion to Roman Architecture* and author of *Roman Woodworking*. He has also consulted for the Department of Defense by developing training materials about fragile archaeological sites for U.S. soldiers in the Middle East.

Lecturers are subject to change.





ITINERARY

Wednesday, October 14, 2015

USA

Depart the U.S. for Rome, Italy.

Thursday, October 15

ROME, Italy | CIVITAVECCHIA | EMBARK

Arrive in Rome, transfer to Civitavecchia, and embark *Corinthian*. (D)

Friday, October 16

TRAPANI, Sicily | SEGESTA

Drive up winding roads to Segesta for a visit to its magnificent Doric temple, built in 420 B.C. and among the best preserved ancient Greek sites. The temple escaped destruction by the Carthaginians in the late 5th century. (B, L, D)

Saturday, October 17

CAGLIARI, Sardinia | SU NURAXI | NORA or CAGLIARI

Arrive in Cagliari, Sardinia's capital, built on a hill facing the sea. Disembark and drive to the village of Barumini to visit Su Nuraxi, Sardinia's most important and impressive nuraghic complex and a UNESCO Heritage of Humanity site. After lunch aboard, spend time at leisure to explore Cagliari on your own, or take an excursion to Nora, whose ancient remains date from the Carthaginian and Roman periods. (B, L, D)

Sunday, October 18

PORTO TORRES

Located at the head of Sardinia's spacious Asinara Bay, Porto Torres, known in antiquity as Turrus Libysonis, was one of the island's most important cities that prospered from its trade with mainland Italy. Abandoned around 1000, it was revived during the later medieval period. Excavations have revealed the remains of temples, baths, streets, and exquisite frescoes and mosaics. We explore the ancient city and also visit the museum, which houses many of the artifacts from the excavations, and the Basilica of San Gavino, the largest Pisan Romanesque church in Sardinia, built in the 11th century. (B, L, D)

Monday, October 19

PALAMOS, Spain | EMPURIES | PALS

From Palamos, on Catalonia's Costa Brava, drive along the coast to Empuries, founded by the Greeks around 600 B.C. Explore the remains of the Greco-Roman cities and, en route back to the ship, stop at the quaint medieval village of Pals. (B, L, D)

Tuesday, October 20

TARRAGONA | POBLET

Sunny Tarragona is a veritable museum-town, containing remains of practically all of the civilizations that crossed the Iberian Peninsula. Explore its Roman remains, including the seaside-facing amphitheater, and visit the Archaeological Museum which includes part of the Roman city walls, frescoes, sculpture, and pottery. Drive to the Catalanian countryside to visit the Monastery of Poblet. Beautifully located at the feet of the Prades Mountains, this impressive Cistercian abbey is one of the largest in Spain and features a 12th-century church at its center. (B, L, D)

Wednesday, October 21

AT SEA

Enjoy *Corinthian's* amenities and onboard lectures as we cruise to Malaga. (B, L, D)

Thursday, October 22

MALAGA | GRANADA

Granada exemplifies the best of Moorish art, architecture, and culture. Tour the Alhambra, a network of lavishly decorated palaces and irrigated gardens begun in the 13th century by the caliphs of the Nasrid dynasty. After the Christian reconquest, the Alhambra's mosque was replaced with a church and additional structures were built. The complex is an architectural marvel of lacy arches, filigreed ceilings, slender columns, intricate stucco work, and romantic courtyards adorned with lovely fountains. Also stroll through the splendid Generalife Gardens, adjacent to the Alhambra, a soothing landscape of pathways, patios, pools, fountains, trees, and flowers of every imaginable hue. (B, L, D)

Friday, October 23

HUELVA | SEVILLE | ITALICA | HUELVA

From Huelva, travel to Seville, one of Europe's most important and affluent maritime cities. Visit the Alcazar, with its charming Murillo Gardens, and the Gothic Cathedral. Also, you may explore the remains of ancient Italica, once the third largest city in the Roman world, or spend time at leisure in Seville. (B, L, D)

Saturday, October 24

LISBON, Portugal

Enjoy the morning at sea before arriving in Lisbon. Stroll through the Alfama, the city's oldest district consisting of snaking alleyways, steep cobblestoned streets, and lively tavernas. See the Museu de Artes Decorativas, set in a lovely 17th-century palacio; the Miradouro de Santa Luzia, which offers a splendid view of the tiled roofs of the Alfama; and the 18th-century church of Santa Luzia. Visit St. George's Castle, built in 1147 by King Afonso Henriques as a residence for the Portuguese kings. After the 1755 earthquake, the ramparts remained in ruins until 1938, when a complete renovation began. Next, choose between a visit to Jeronimos Monastery, the culmination of Manueline architecture, or the Gulbenkian Museum, housing one of the finest collections of art in Europe, before returning to the ship. (B, L, D)

Sunday, October 25

LISBON | DISEMBARK | USA

Disembark and transfer to the airport for return flights. (B)



Monastery of Poblet at the foot of the Prades Mountains



CORINTHIAN SETS THE STANDARD FOR PRIVATE-STYLE CRUISING

In an era of mega cruise ships carrying thousands of passengers, *Corinthian* is a delightful alternative, accommodating only 100 guests in 50 suites. *Corinthian* attracts travelers for its custom itineraries, limited guest capacity, and a style of cruising rarely found today. All suites face outside and include two twin-size beds convertible to a queen-size bed, sitting area, safe, mini-refrigerator, closets, climate control, telephone, TV, DVD/CD player, Internet connection, and private bathroom with shower. Several have a private balcony. The ship has ample deck areas, a gym, spa, salon, library (with Internet access), lounges, Jacuzzi, outdoor cafe, elevator, doctor, Wi-Fi, and a restaurant accommodating all guests in an open seating. *Corinthian* meets the latest safety/health regulations and features 65 officers and crew, the most current navigational and communications technology, an ice-strengthened hull for polar voyages, retractable fin stabilizers, and Zodiac craft for forays ashore.



Lounge



Veranda Suite



Sun Deck

DECK PLAN

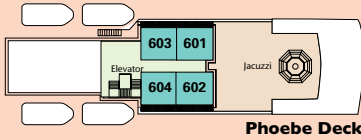

Phoebe Deck

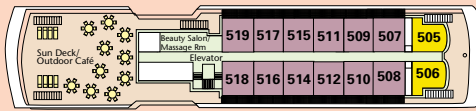

Cleo Deck

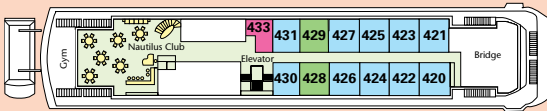

Leto Deck

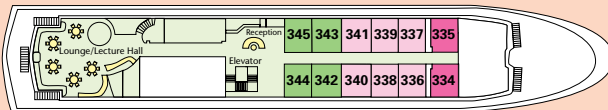

Ariadne Deck

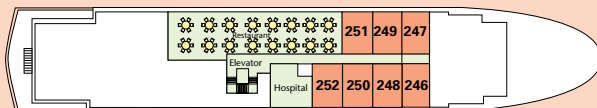

Athena Deck



Restaurant

NEW REDUCED RATES

- Save **\$2,800** per couple
- For solo travelers, single supplement waived plus save **\$1,400** per person

CRUISE & LAND RATES PER PERSON

All accommodations aboard *Corinthian* are suites. They face outside, affording sea views, and include a bedroom with two twin-size beds that can convert to a queen-size bed, sitting area, mini-refrigerator, safe, spacious closets, climate control, telephone, TV, DVD/CD player, Internet connection, and bathroom with marble vanity, shower, and other amenities. All suites are non-smoking.

CATEGORY	DESCRIPTION	ORIGINAL RATE	REDUCED RATE	YOU SAVE
E	Deluxe suites on Ariadne and Leto Decks with windows and sitting area. 215 sq. ft. Suites *342 - *345, *428, *429 *PARTIALLY OBSTRUCTED VIEW	\$8,690	\$7,290	\$1,400
D	Deluxe suites on Ariadne and Leto Decks with windows and sitting area. 215 sq. ft. Suites 334 - 335, 433	\$9,390	\$7,990	\$1,400
C	Deluxe suites on Athena Deck with portholes and sitting area. 275 sq. ft. Suites 246 - 252	\$10,090	\$8,690	\$1,400
B	Deluxe suites on Ariadne Deck with windows and sitting area. 225 sq. ft. Suites 336 - 341	\$11,090	\$9,690	\$1,400
A	Deluxe suites on Leto Deck with windows and sitting area. 235 sq. ft. Suites 420 - 427, 430 - 431	\$11,890	\$10,490	\$1,400
AA	Deluxe suites on Cleo Deck with forward windows and sitting area. 285 sq. ft. Suites 505 - 506	\$12,390	\$10,990	\$1,400
VS	Deluxe Veranda Suites on Cleo Deck with private balcony and sitting area. 245 sq. ft. Suites 507 - 519	\$13,290	\$11,890	\$1,400
PHS	Deluxe Penthouse Suites on Phoebe Deck with private balcony and sitting area. 260 sq. ft. Suites 601 - 604	\$14,290	\$12,890	\$1,400

Port taxes & charges: \$600 per person

SINGLE OCCUPANCY: The single supplement of \$1,990 is waived. Also save an additional \$1,400 per person.

PROGRAM INCLUSIONS

Included

- 10-night cruise aboard the all-suite, 50-cabin *Corinthian*
- Complete program of tours and excursions
- Welcome and farewell cocktail receptions aboard ship
- All meals aboard ship
- Wine with lunch and dinner aboard ship
- Educational program of lectures and discussions, including Carleton faculty leaders Dana and Stephen Strand
- Professional Travel Dynamics International tour staff
- Complete pre-departure materials
- Baggage handling and airport transfers abroad on the designated program arrival and departure dates
- Gratuities to porters, guides, and drivers

Not Included

- Airfare
- Visa and passport fees (if applicable)
- Trip cancellation and baggage insurance
- Meals and beverages other than those specified above
- Personal expenses (such as laundry, telephone, Internet)
- Port taxes and charges
- Gratuities to shipboard personnel

Air Reservations

Airfare is not included in the Cruise and Land Rates. To make your air reservations, please contact your preferred airline, travel agent, or the Travel Dynamics International air desk toll-free at 1-877-711-9896 Monday – Friday from 9:00 am – 5:00 pm (EST). Please mention tour code 15215RP for reference.

For questions and to hold your space, please contact Carleton College Alumni Adventures at:

800-811-7244

Toll: 603-756-4844 • Fax: 603-756-2922

Email: carleton@studytours.org

Website: go.carleton.edu/adventures

REGISTRATION

CARL 15215RP

To hold your reservation for seven days while this form and your deposit are in the mail, please contact us at 800-811-7244 or carleton@studytours.org

Please send your deposit and this form to:

Carleton College Alumni Adventures

P.O. Box 938, 47 Main Street, Suite One

Walpole, NH 03608-0938

Fax: 603-756-2922

Enclosed is my check or credit card no. for \$ _____ (\$1,500 per person) as a deposit to hold _____ place(s) on ***The Mediterranean Sea and Civilization***.

I understand that final payment is due ninety (90) days prior to departure and is payable by check only.

Please make check payable to: **EOS Passenger Account - CAA Mediterranean10/15**

AmEx Discover Visa MasterCard

No. _____ Exp. _____

3- or 4-Digit Security Code _____

Please select cabin category in order of preference:

PHS ___ VS ___ AA ___ A ___ B ___ C ___ D ___ E ___

Twin Beds Double Bed

Single Occupancy Share (cannot be guaranteed)

DR./MR./MRS./MS. FIRST LAST CARLETON CLASS OF

DR./MR./MRS./MS. FIRST LAST CARLETON CLASS OF

ADDRESS

CITY/STATE/ZIP

TELEPHONE (DAY)

(EVENING)

E-MAIL

Each participant must sign below: I/We have read the "General Information" section and agree to its terms.

SIGNATURE

DATE

SIGNATURE

DATE

GENERAL INFORMATION

PAYMENT SCHEDULE: A deposit of \$1,500 per person is required to reserve your space on the tour. For your convenience, you may charge your deposit to your American Express, Visa, Discover, or MasterCard. Final payment is due 90 days prior to departure. Credit cards are not accepted for final payment. However, personal checks are accepted for both deposits and final payment.

CANCELLATIONS & REFUNDS: All cancellations are subject to a \$300 per person fee. Cancellations received 61-90 days prior to departure will be assessed a penalty equal to 50% of the total program cost per person. Cancellations received within 60 days of departure are subject to 100% cancellation penalties.

INSURANCE: We strongly recommend the purchase of trip cancellation insurance, which is available for coverage of expenses in conjunction with cancellation due to illness or accident. Baggage insurance is also recommended. In the event that you must cancel your participation in a travel program, trip cancellation insurance may be the only source of reimbursement. Insurance information will be provided upon registration.

ITINERARY: The itinerary, accommodations, and arrangements are subject to change at the discretion of Travel Dynamics International Ltd.

RESPONSIBILITY: Please read carefully the following terms and conditions, which constitute the sole, legally enforceable agreements between the passenger and Travel Dynamics International Ltd and the tour's sponsoring organization. The passenger is also advised to review his/her separate ticket passage contract with the vessel's owner/operator, which will constitute the sole, legally enforceable terms of carriage for this cruise and is available on request from Travel Dynamics International Ltd. Travel Dynamics International Ltd. and the tour's sponsoring organization act solely as agents for the passenger with respect to all transportation, hotel and other tour arrangements. In that capacity, we exercise all reasonable care possible to ensure the passenger's safety and satisfaction, but, we neither assume nor bear any responsibility or liability for any injury, death, damage, loss, accident, delay or irregularity arising in connection with the services of any ship, airplane, train, automobile, motor coach, carriage or other conveyance, or the actions of any third-party, involved in carrying the passenger or in affecting these tours. We are not responsible for damages, additional expenses, or any other losses due to cancellation, delay or other changes in air or other services, sickness, weather, strike, war, civil disturbances, acts or threats of terrorism, travel warnings or bans, termination or suspension of war risks or other carrier insurance, quarantine, acts of God or other causes beyond our control. All such losses must be borne by the passenger, and tour rates provide for arrangements only for the time stated. In the event of cancellation, delay or rescheduling mandated by any of the aforesaid causes beyond our control, the passenger shall have the option of accepting in lieu of the original tour such rescheduled tour or other substituted tour(s) as may be offered by us, or else, receiving a refund of as much of such advance tour expenditures as we are able to recover on the passenger's behalf from carriers, third-party tour vendors, etc., but, we shall not have any obligation or liability to the passenger beyond the foregoing. We reserve the right to make alterations to the tour's itinerary and to substitute hotels, ships, or lecturers if this is required. We reserve the right to cancel, delay, or reschedule any tour prior to departure, and, so long as this is not due to any of the aforesaid causes beyond our control, the passenger shall be entitled to a full refund of all monies paid to that point if he/she so desires. No refund shall be made for any unused portion of any tour. By forwarding their deposit(s), the passenger certifies that he/she and/or their dependents, minors or others covered thereby do not have any mental, physical or other condition of disability that could create a hazard for them or other passengers. We reserve the right to decline to accept or to decline to retain any person as a member of any tour should such person's health, condition or actions adversely affect or threaten the welfare or safety of other passengers or impede the tour. Baggage or valuables brought on the tour shall be transported, handled or stored at the passenger's risk entirely, and, we shall bear no liability or responsibility for any damage or other loss thereto. Passenger tickets are not transferable and are not subject to alteration by the passenger. No suit shall be maintainable against the carrier, or vessel, for any losses, accidents, damages to person, property, personal injury (including death or other types of bodily injury) of the passengers, unless written notice of the claim, with full particulars, is delivered to the carrier or its agents at its office at the port of sailing or at the port of termination within six months from the day when such incident occurred. In no event shall any such suit or any claim against the carrier or vessel for any losses, accidents, damages to person, property, personal injury (including death or other types of bodily injury) of the passenger be maintainable unless such suit is commenced within one year from the day when the incident causing such losses, accidents, damages to person, property, personal injury (including death or other types of bodily injury) of the passenger occurs, notwithstanding any provision of law of any state or country to the contrary. Resolution of any disputes arising hereunder shall be brought within the United States District Court for the Southern District of New York, pursuant to the applicable general maritime law, and applying the applicable general maritime law and Federal maritime statutes.

RATES: Tour costs are based upon current airfares, tariffs, and currency values. While we do everything possible to maintain the listed prices, they are subject to change.

FUEL SUPPLEMENT: Travel Dynamics International Ltd. reserves the right to charge a fuel supplement, without prior notice, if the NYMEX oil price exceeds \$85 per barrel. This supplement may be charged even if the cruise fare has been paid in full.

SHIP'S REGISTRY: Malta

CST #204 3599-40 TDI

Carleton College

ALUMNI ADVENTURES
Explore the world

P.O. Box 938, 47 Main Street, Suite One, Walpole, NH 03608

PRSRT STD
U.S. Postage
PAID
Travel Dynamics
Int'l

The Mediterranean Sea and Civilization

Aboard the All-Suite, 50-Cabin *Corinthian*
October 14 – 25, 2015

CARL 15215RP

NEW REDUCED RATES

- Save **\$2,800** per couple
- For solo travelers, single supplement waived plus save **\$1,400** per person

*The spectacularly green hillsides
of Segesta, Sicily*

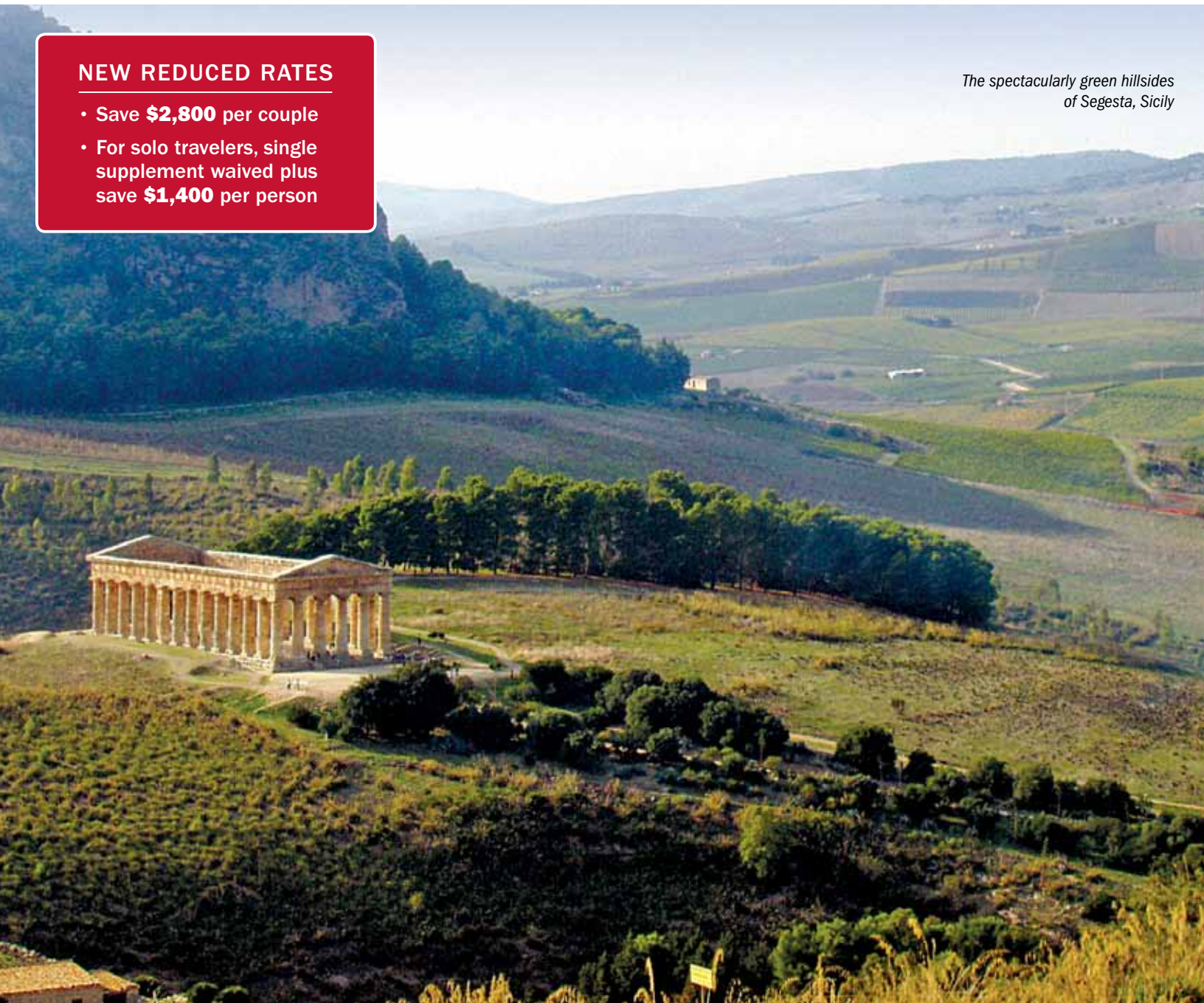

For questions and to hold your space, please contact
Carleton College Alumni Adventures at: 800-811-7244
Toll: 603-756-4844 • Fax: 603-756-2922
Email: carleton@studytours.org
Website: go.carleton.edu/adventures

With Carleton College Professors
DANA & STEPHEN STRAND
